

EARTHMAT FOR THE PROPOSED 66/11 KV SUB-STATION @ NARASIMHAGIR, BELLIGATTA), KUDLIGI (T), BALLARI (D).

IMPORTANT

* NOT TO SCALE

* THE NO OF CAST IRON PIPE ELECTRODES SHALL BE PROVIDED AS PER GUIDELINES*

* BEFORE EXECUTION PLEASE CAREFULLY GO THROUGH THE ENCLOSED GUIDELINES *

* ALL DIMENSIONS ARE IN METER

SALIENT DESIGN FEATURES

AREA COVERED BY EARTHMAT IN SQ MTR

DEPTH OF BURIAL OF EARTHMAT IN MTR

SPACING BETWEEN MAT CONDUCTOR (M.S. FLAT) IN MTR

SIZE OF EARTHMAT CONDUCTOR (M.S.FLAT) IN MM

SPREADING OF GRANITE METAL JELLY OF SIZE 20/25 MM

TO A HEIGHT OF 100 MM OVER THE ENTIRE EARTH MAT AREA.

BILL OF MATERIALS (APPROXIMATE QUANTITY) FOR EARTHMAT FORMATION & FENCING.

(AS PER THE LAYOUT DRAWING NO.KPTCL/TECH/SS-66/1145-A DATE:4.6.2025)

1.Excavation,formation,refilling

2.Material for formation of earthmat as per specification

a)M.S.Flat 75 X 12 MM

b)MS Round rods 40 mm dia,1.075 Mt. long

c)G.I.Flats 75 X 12 MM for earth connection

d)Cast iron pipe electrodes of 100 mm Id,13 mm thick,2.75 mtr.long

e)Spreading of Granite metal jelly of size 20/25 mm size to a height of 100 mm

3392 Cntr.

7613 Mtr.

162 No.

1712 Mtr.

48 No.

840 Cntr.

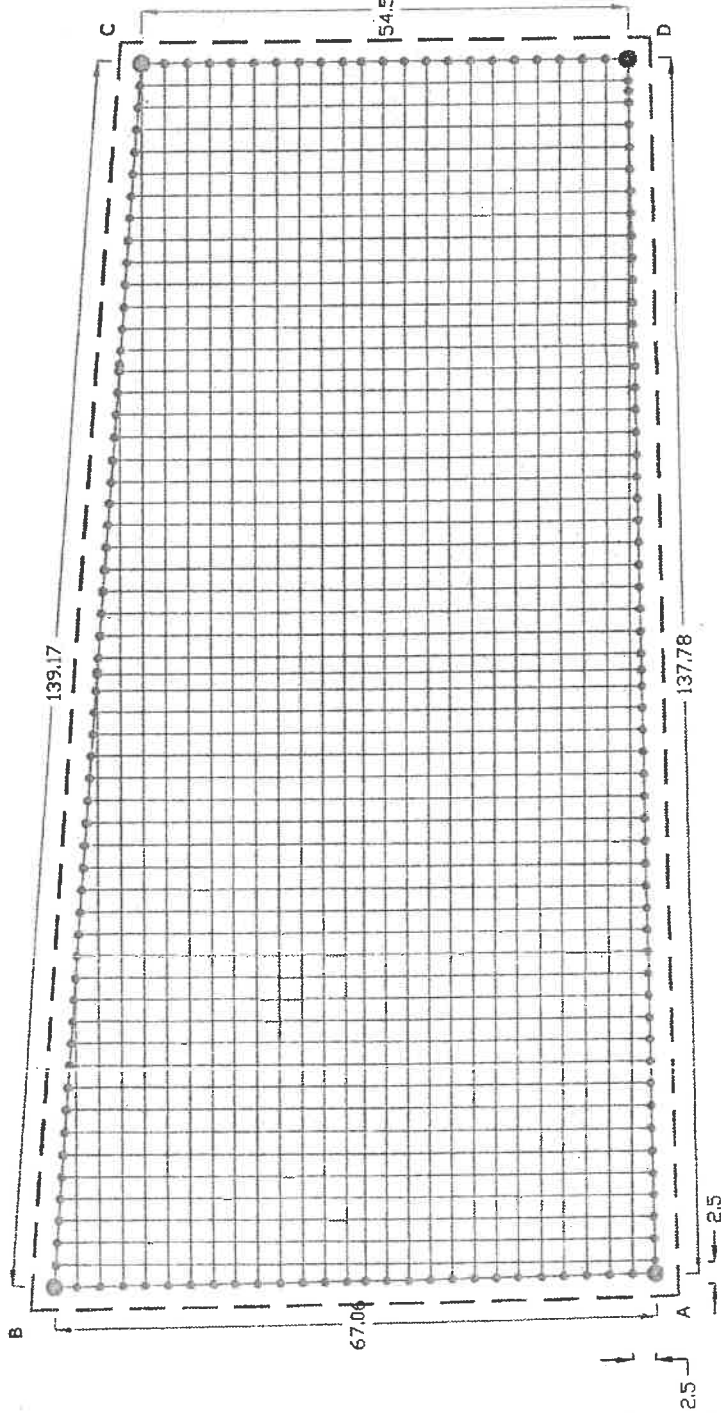

NOTE:

1. EARTHMAT DESIGNED BY CONSIDERING BREAKER
STC OF 40 KA WITH 0.6 GRID FACTOR.

2. 'ABCD' INDICATES PROPOSED EARTH MAT OF
AREA 8404 SQ MTR WITH 75 X 12 MM FLAT OF
2 MTR SPACING.

3. PROPOSED EARTHMAT SHALL BE EXECUTED DULY
OBSERVING R&D GUIDELINES.

- FENCE SHALL BE AT A MINIMUM DISTANCE OF 1.5 METERS AWAY FROM THE PERIPHERY OF THE STATION EARTHMAT
- 40 MM DIA M.S. ROUND RODS OF LENGTH 1.075 METER TO BE DRIVEN AS SHOWN
- C.I.PIPE ELECTRODES PROPOSED (MIN 5.5 MTR SPACING SHALL BE MAINTAINED BETWEEN ANY TWO ELECTRODES)

R & D CENTRE, K P T C L

DRG NO. SEE/R&D/EEE/KCO-116/F-52(11)/2025-26 Dtd. 12-6-2025

13/6/25

13/6/25

13/6/25

13/6/25

13/6/25

13/6/25

13/6/25

13/6/25

13/6/25

